

This 18 acre park was designed originally by Frederick Law Olmsted. The rolling topography and mature pines were severely impacted by more recent playing fields scattered all over the park. A Design II studio used this opportunity to explore the design process while offering the City of Newton the first step in their renovation project.

After an initial meeting with the neighborhood, the students undertook to renovate the park while keeping alive the spirit of Olmsted. A more visible and grand entrance was created for the park with a sitting area near the entrance. The small pine knoll was of great interest and was expanded and enhanced. The class was intrigued by the stone work along Hammond Brook and the pump house, decided to use stone as part of their design vocabulary, and created a small stone amphitheatre. The active recreation areas were consolidated, and the playground moved closer to the street to make it more accessible. Picnic tables and barbecue pits became a buffer between the active and passive recreation areas. The designers created a pond and used the curving path system to enhance visibility of the water.



The thoughtful and comprehensive designs presented to the Landscape Advisory Council were received with enthusiasm and pleasure that the

students could offer the town several designs which honored Olmsted while making the playground usable for today's recreation.

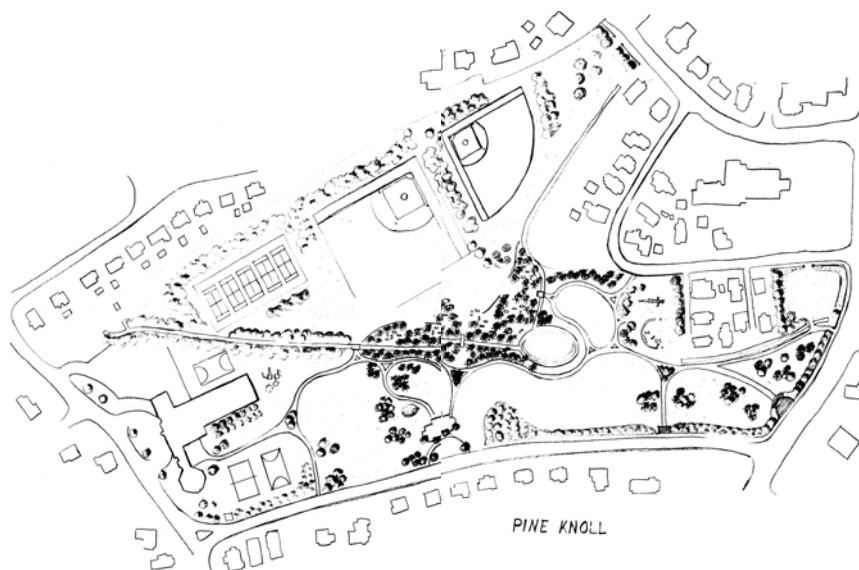

Client: Landscape Advisory Council
City of Newton, MA

Designers: Radcliffe Seminars
Design II Studio: Methods
Jean Cavanaugh, Instructor

Completion: Spring, 2001