

The Southwest Corridor Farm Community Garden is one of the oldest in the city. It is worked by a diverse group of about 40 gardeners, some very experienced and some just starting out. The garden is divided in half by a gravel driveway and a narrow strip of lawn. The gardeners would like to see this “centerpiece” developed into a hospitable place to gather and socialize.

A COG designer met with the gardeners in community meetings as well as with a small steering committee. A base map was created showing existing conditions and site constraints. Surveys were distributed, and the diverse responses were consolidated into a design program. The gardeners’ wish list included decorative plantings, play space for children, a mini-orchard, space for large area crops, arbors, seating, and many other garden dreams.

The final plan provides space for a remarkable variety of activities. The once bleak drive is transformed into an area that is both beautiful and useful. Children have a place to play. Communal spaces for a small orchard, berry patches, herb gardens, sprawling crops, a grape arbor, and a cutting

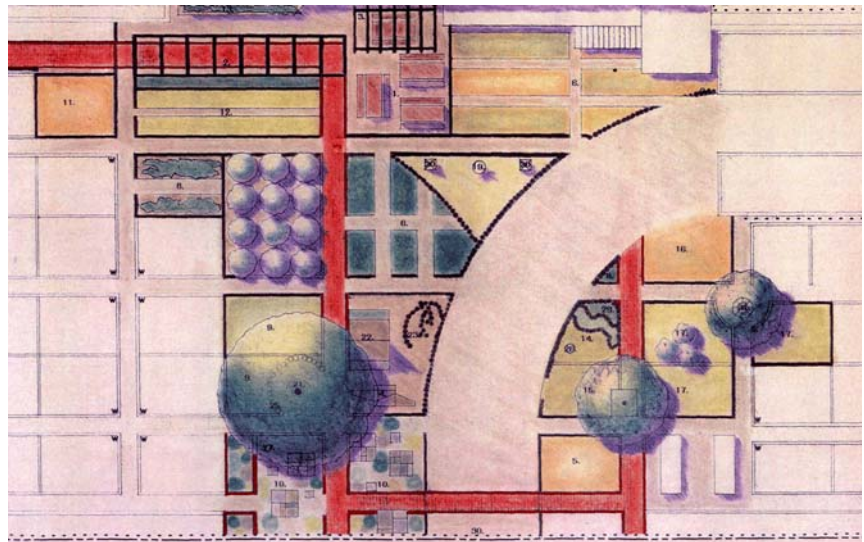

garden supplement the individual gardens. Vine covered obelisks and a pergola lend an air of formal beauty and set the stage for social as well as gardening activities.

The gardeners plan to install the new elements themselves, and the designer has provided some construction details to aid them. Both planting schemes and paving patterns are suggested as are other details which will turn a working space into a satisfying and beautiful community asset.



Client: Southwest Corridor Farm
Community Garden,
Jamaica Plain, MA

Designer: Sunny Doherty
Needham, MA

Completion: Spring, 1999

